

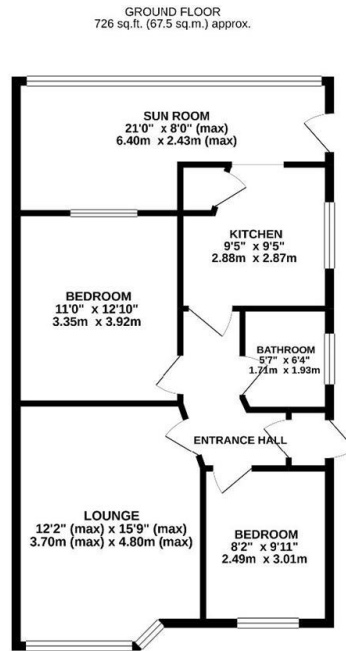

PRICE: £275,000



TOTAL FLOOR AREA: 726 sq.ft. (67.5 sq.m.) approx.  
While every attempt has been made to ensure the accuracy of the floorplan contained here, measurements of walls, windows, doors and any other items are approximate and no responsibility is taken for any error or omission in this document. This plan is for illustrative purposes only and should be used as a guide for any prospective purchaser. The services, systems and appliances shown have not been tested and no guarantee is given regarding their operation or efficiency in the future.  
Made with Metagon 10/2021



## Maple Drive, Denmead, PO7 6QQ

Semi-detached bungalow located in a popular Denmead location. Accommodation includes lounge, kitchen, full width sun room, two bedrooms and bathroom. Worcester condensing boiler. South-easterly aspect rear garden. Vacant and offered for sale with **NO FORWARD CHAIN.**

### Agents notes:

We have not tested any systems or appliances and no warranty as to the condition or suitability is confirmed nor implied. All measurements are approximate.

These particulars are thought to be materially correct but their accuracy is not guaranteed and they do not form part of any contract.

#### Entrance Porch

UPVC front door, obscure glazed wooden front door, parquet flooring.

#### Entrance Hall

Parquet flooring, polystyrene tiled ceiling.

Access to loft area (not boarded) via retractable ladder.

#### Lounge

Secondary glazed window to front aspect, electric fire set in surround and hearth, tongue and groove clad wall with cupboard and display shelves, radiator, textured ceiling.

#### Kitchen

Range of wall and base units with work surfaces including stainless steel sink drainer with mixer tap, space and plumbing for washing machine and space for cooker. Cupboard housing fuse board and electricity meter, double glazed window to side aspect, radiator, smooth ceiling.

#### Sun Lounge

Double glazed window to rear aspect, UPVC door to side, radiator, tongue and groove clad ceiling.

#### Bedroom One

Glazed window to rear aspect, built in wardrobe cupboards, radiator, textured ceiling with coving.

#### Bedroom Two

Secondary glazed window to front aspect, built in storage cupboard housing Worcester combination boiler, radiator, smooth ceiling.

#### Bathroom

Coloured suite comprising panel enclosed bath, pedestal sink and low level WC. Tiled floor, tiled splash back, heated towel radiator, obscure double glazed window to side aspect, smooth ceiling.

