

PRICE:£185,000

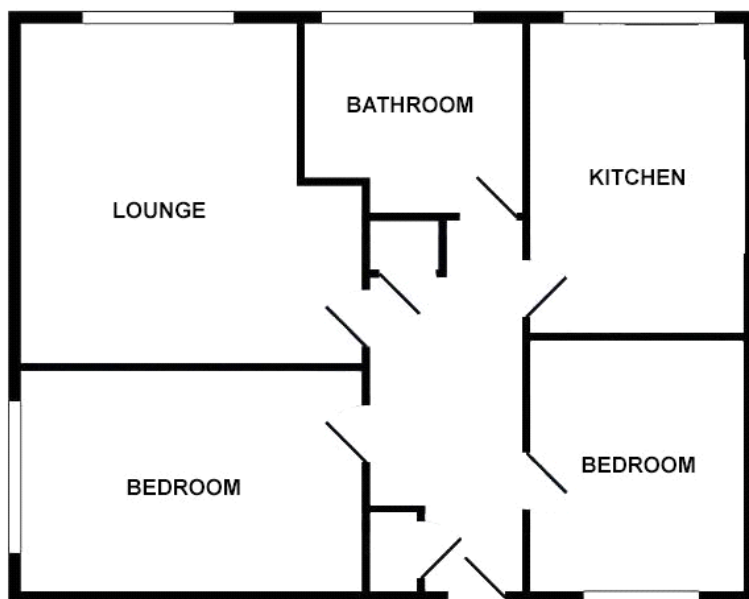

Redwood Court, Waterlooville, PO7 7TQ

GREAT INVESTMENT / FIRST TIME PURCHASE. TWO BEDROOM FIRST FLOOR FLAT conveniently situated just outside of Waterlooville town centre. Features include updated kitchen and bathroom, Vaillant combination boiler, triple glazed windows (where stated), covered allocated parking space and outside store.

Agents notes:

We have not tested any systems or appliances and no warranty as to the condition or suitability is confirmed nor implied. All measurements are approximate.

These particulars are thought to be materially correct but their accuracy is not guaranteed and they do not form part of any contract.

To verify flood risk of this property please see the following link;

<https://check-long-term-flood-risk.service.gov.uk/risk>

Entrance

Stairs to first floor, obscured double glazed front door, radiator, textured ceiling with coving, storage cupboard with hanging rail, additional cupboard housing consumer unit, gas and electricity meters.

Lounge

W: 13' 10" x L: 13' 9" (W: 4.21m x L: 4.18m)

Triple glazed window to front aspect, radiator, textured ceiling with coving.

Kitchen

W: 8' 5" x L: 11' 9" (W: 2.57m x L: 3.58m)

Modern matching range of wall and base units complemented with work surfaces over incorporating stainless steel sink unit with drainer and mixer tap, electric oven, four burner gas hob, extractor canopy over, space for freestanding fridge/freezer, space and plumbing for washing machine, luxury vinyl flooring, radiator, double glazed window to front aspect, airing cupboard with shelving and wall mounted Vaillant combination boiler fitted (approximately 2023) textured ceiling.

Bedroom One

W: 13' 10" x L: 9' 1" (W: 4.23m x L: 2.76m)

Triple glazed window to side aspect, radiator, textured ceiling with coving.

Bedroom Two

W: 8' 5" x L: 11' (W: 2.56m x L: 3.34m)

Double glazed window to rear aspect, radiator, textured ceiling with coving.

Bathroom

Modern white suite comprising low level close coupled WC, panel enclosed bath with mixer tap and shower, sink with mixer tap set in vanity unit, luxury vinyl flooring, double glazed obscured window to front aspect, radiator, textured ceiling with coving.

Please Note

Service Charge: £130.00 pcm

Length of lease: 950 years from 1977.

OUTSIDE

Communal gardens, one covered allocated parking, outside store. Two visitor parking spaces.

Directions

Proceeding south on London Road from Waterlooville town centre, Redwood Court is located on the left hand side on the corner of Winifred Road.

To access the parking, turn left into Winifred Road, left into Freshfield Gardens and left into the Redwood Court car park.

